

MahaRERA Registration No. P51800024414  
Available on website: maharera.mahaonline.gov.in

Site Add.: Sumer Life, Opp. Nahar Amrit Shakti,  
Near Kherani Baug, Chandivali Farm Road, Nr.Powai, Mumbai - 400 072.



Fax: +91 22 2490 1919 | www.sumergroup.co.in  
Corporate Office : 203, A Wing Peninsula Corporate Park, Ganpatrao Kadam Marg, Lower Parel, Mumbai - 400 013.

The information contained in this brochure including but not limited to layout plans, specifications, designs, elevations, features, salable carpet area, amenities, facilities and services are only indicative of the kind of development that is proposed and its finality is subject to the approval of the respective authorities or as required by Sumer Corporation in the interest of continuing improvement. All images are artistic conceptualization for illustration only and do not purport to exactly replicate the products. Any furniture & fixtures shown here are not part of the offering & are purely for showcasing possibilities. Sumer Corporation reserves the right to make changes or alterations, without prior notice or obligation. The actual layout plans, specifications, designs, elevations, features, RERA carpet area, amenities, facilities and services that are approved by the Competent Authority and offered to the Allottee shall be defined in the Agreement for Sale. The purchase price of the Apartment as mentioned above, is determined on the basis of above referred RERA Carpet area of the apartment only which Allottee/s agree/s and confirm/s. Thus, the other appurtenant area such as terrace if any, balcony if any, service shaft if any, exclusive verandah, if any, Common Amenities, etc are neither included in the carpet area nor are considered for determining the purchase price. Kindly visit the MahaRERA website at <https://maharera.mahaonline.gov.in/> for currently approved layout plans, specifications, designs, elevations, features, RERA Carpet Area, amenities, facilities and services. The RERA No. for the Project is P51800024414.

thoughttrains



# LIFE ALL INCLUSIVE

## RETAIL BROCHURE

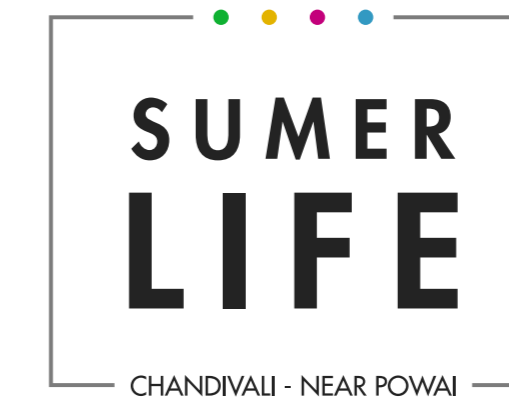





Artist's Impression

# A WORLD

OF SHOPPING & DAILY CONVENIENCE  
NOW AT YOUR DOORSTEP

- Frontage with Glass Doors and Rolling Shutters
- Banquet, Food Court & Play Area on 2nd floor
- Slab-to-slab height - **4.1 mtrs. / 13.44 ft.** & Finished height- **3.28 mtrs. / 12.5 ft.**
- Ample Car Parking
- 2 Dedicated Air Conditioned Elevators
- A world of shopping & daily convenience now at your doorstep
- Up to 5 ft. Branding for all shops

SUMER LIFE-  
A CENTRALLY LOCATED LANDMARK WITH BEST  
**CONNECTIVITY**  
AND ACCESSIBILITY

LOCATION ADVANTAGE

PROMINENT LANDMARKS



SEEPZ  
5.3 Kms

Powai  
2.8 Kms

BKC  
7.3 Kms

International  
Airport 5.9 Kms

NEAR BY METRO & RAILWAY STATION



Jagruti Nagar  
Metro Station 2.1 Kms

Sakinaka Metro Station  
3.4 Kms

Proposed Metro Station  
3.3 Kms

Andheri Station  
8.6 Kms

PROMINENT HIGHWAYS



JVLR  
4.7 Kms

Saki Vihar Road  
3.4 Kms

LBS Road  
3.3 Kms

DAY TO DAY / RETAIL SHOPPING



Dmart Powai  
2.8 Kms

R City  
4.3 Kms

Phoenix Marketcity  
5.0 Kms

PROMINENT EDUCATIONAL INSTITUTE



Hiranandani School  
2.4 Kms

Bombay Scottish School  
2.4 Kms

HOSPITALITY



The Leela Hotel  
4.4 Kms

Note: The above mentioned distance is indicative & measured from Google Map. Travel time is based on normal traffic conditions

LOCATION MAP

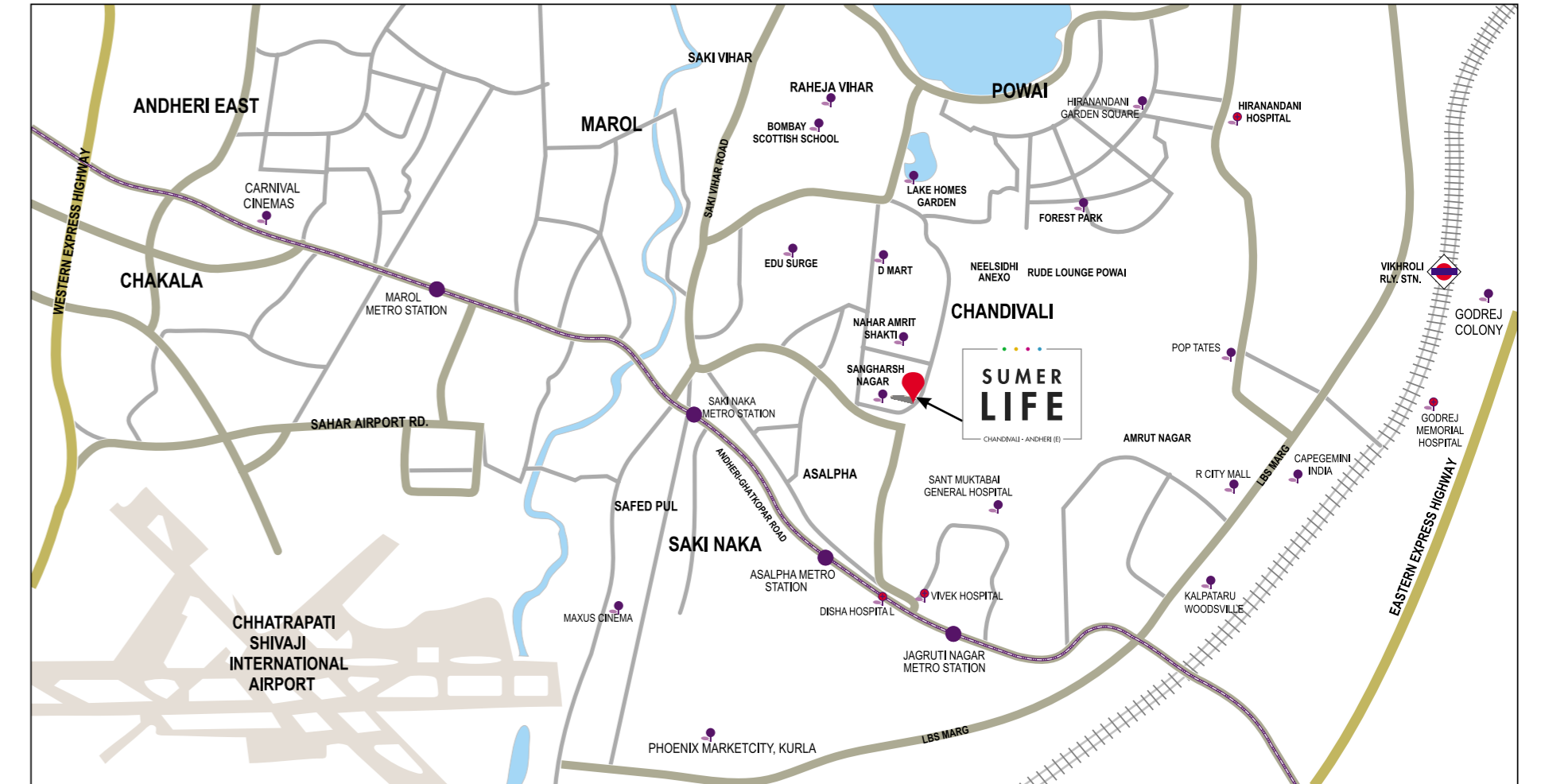

LOCATION HIGHLIGHTS

- A Well-developed Suburb Locale Situated Between Powai Lake & Saki Naka
- Celebrated Address with Chandivali Studio Famous for Film & TV Shoots
- Surrounded by Nature with Mesmerising Views of Powai Hills & Lake
- Proximity to Schools, Colleges, Hospitals, Malls, Supermarket, Banks etc.
- Home of Numerous Renowned Commercial & Business Parks like Oberoi Garden, Boomerang, Hiranandani Shopping Complex etc.

# DESIGN TO SAFETY, THE RETAIL SPACE IS FULLY EQUIPPED

## FEATURES FOR YOUR BUSINESS

- Service Area
- Fire Compliant
- Air conditioned common areas
- AHU rooms
- DG Set
- Generator back-up for common areas
- Electric Room
- Separate washrooms for his & her
- Separate Society office at 2nd floor
- Warm Shell
  - Vitrified Tiles
  - POP walls
- Fire Alarm System
- Security Monitoring Room
- CCTV Cameras
- 24X7 Manned Security

Disclaimer: The information in this collateral is indicative of the kind of development that is proposed. Subject to the approval of the authorities or in the interest of continuing improvements, the developer reserves the right to change the layout, plans, specifications features, brands used or amenities without prior notice or obligation. The amenities shown inside the images in the brochure are purely indicative. All amenities, fixtures, brands, tiles, etc. mentioned in the brochure or displayed in the show/sample flats are subject to availability and quality checks of the specific design at the time of execution and implementation. This Advertisement/printed material does not constitute an offer or contract of any nature whatsoever between the promoters and the recipient. All transactions in this development shall be subject to and governed by the terms & conditions of the agreement for sale to be entered into between the parties. Carpet area is calculated as per Circular No. 4/2017 dated 14.06.2017 (MahaRera/Secy/File No. 27/84/2017) issued by Maharashtra Real Estate Regulatory Authority under the Real Estate (Regulation & Development) Act, 2016 and the rules and regulations made thereunder.



Images for representation purpose only

# GROUND FLOOR

GROUND FLOOR FRONT

Shop No.	Total Area in Sq. Ft.
13	226.04
12	308.08
11	419.53
10	243.59
9	242.47
8	252.47
7	253.59
6	243.59
5	245.28
4	253.58
3	267.73
2	267.73
1	267.73
24	383.08
25	315.48
26	288.91
27	278.24
28	273.32
29	283.97
30	257.13
31	246.45
32	186.65
50	775.81

GROUND FLOOR - REAR

Shop No.	Total Area in Sq. Ft.
14	221.44
15	216.27
16	230.54
17	229.10
18	220.01
19	221.43
20	229.10
21	242.00
22	242.00
23	242.00
39	237.46
38	221.44
37	218.56
36	221.44
35	236.77
34	217.41
33	381.45

GROUND FLOOR - CORE

Shop No.	Total Area in Sq. Ft.
40	206.76
41	285.81
42	279.41
43	263.31
44	152.30
45	309.47
46	190.05
47	232.57
48	235.44
49	181.70



# GROUND FLOOR



# FIRST FLOOR

## FIRST FRONT FLOOR

Shop No.	Total Area in Sq. Ft.
14	142.72
13	258.17
12	258.85
11	265.04
10	265.01
9	263.30
8	274.27
7	276.00
6	265.04
5	266.82
4	276.00
3	291.54
2	291.54
1	291.52
24	292.88
25	286.56
26	345.16
27	313.23
28	301.88
29	296.65
30	305.35
31	279.42
32	268.07
33	2,393.60
52	222.10

## FIRST FLOOR - REAR

Shop No.	Total Area in Sq. Ft.
15	125.45
16	220.04
17	246.46
18	243.67
19	234.00
20	235.51
21	243.67
22	211.21
23	204.68
40	204.52
39	252.61
38	235.51
37	232.46
36	235.51
35	254.89
34	254.67
51	194.85

## FIRST FLOOR - CORE

Shop No.	Total Area in Sq. Ft.
41	159.13
42	156.07
43	220.22
44	223.27
45	216.68
46	209.95
47	267.50
48	208.08
49	208.70
50	302.75



# FIRST FLOOR

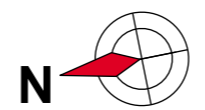

## SECOND FLOOR

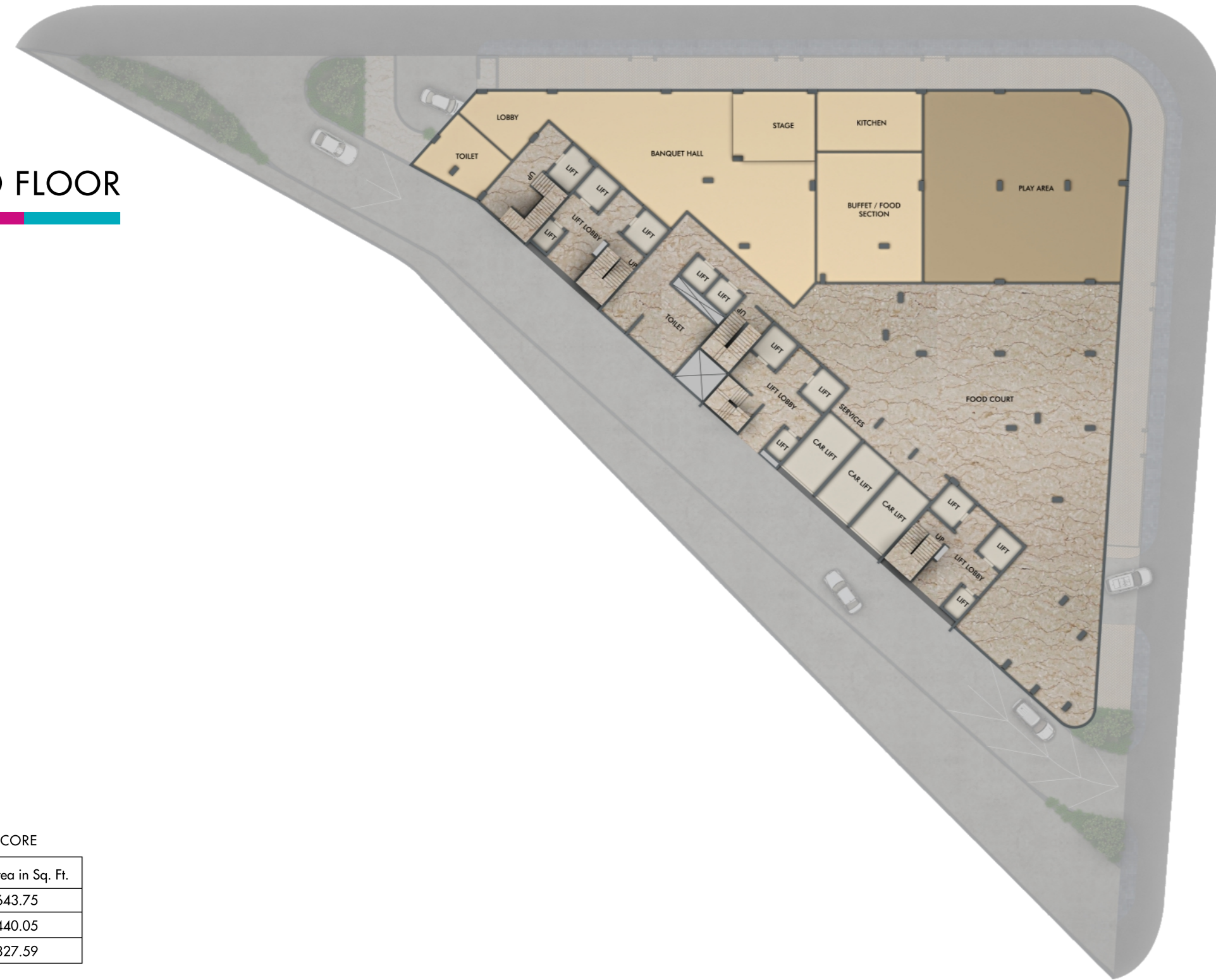

SECOND FLOOR - CORE

	Total Area in Sq. Ft.
Banquet hall	5643.75
Play Area	3440.05
Food Court	7827.59

## SECOND FLOOR

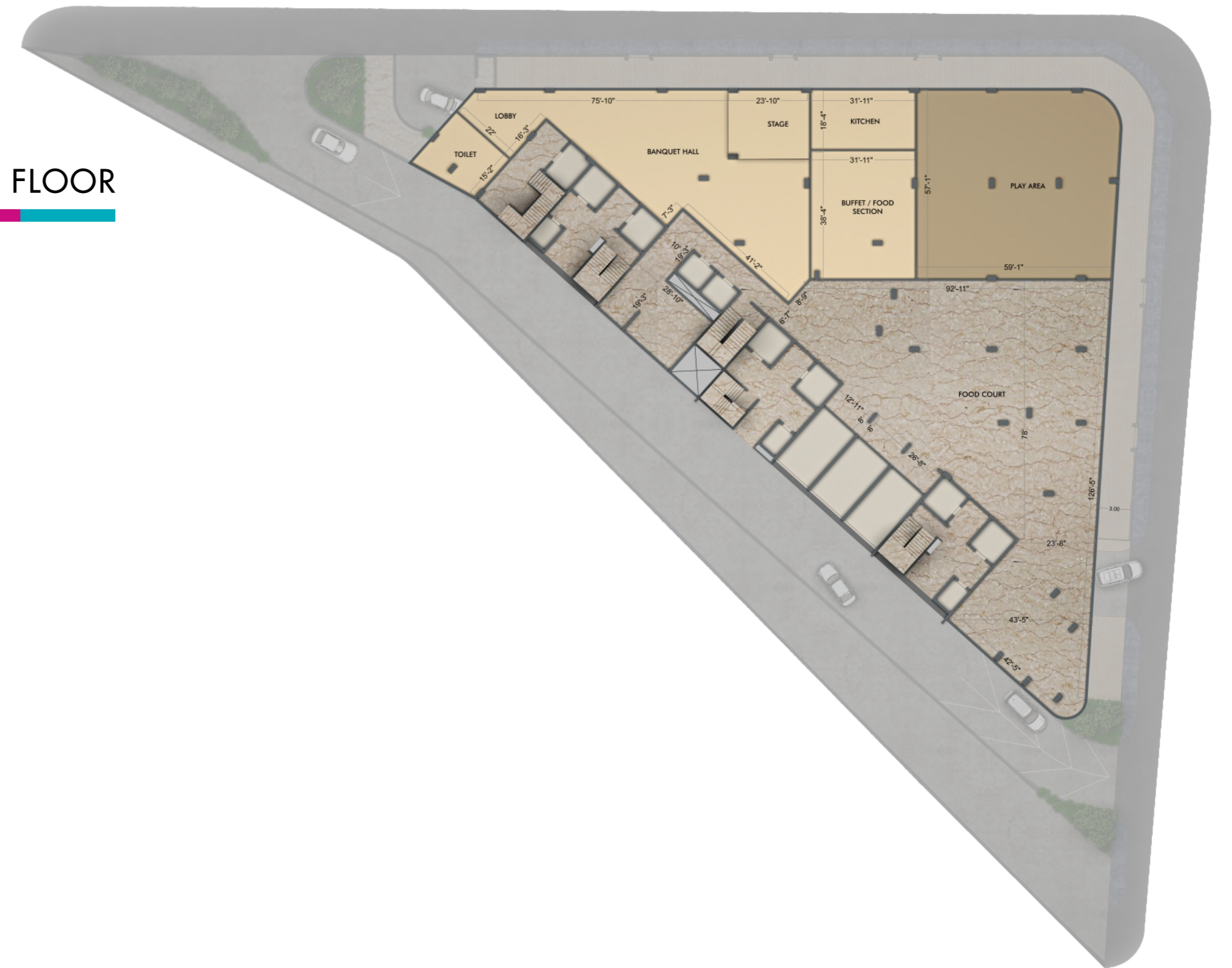



# RETAIL REDEFINED, YOUR SPACE YOUR DREAM GET THE GROWTH YOU ENVISIONED.

## AMBIENCE & IMPRESSION

### EFFICIENT DESIGN

- Ground + 2 Storey Tower
- Seamless Glass Façade
- Affordable Space for Small Businesses
- Larger Floor Plates available
- Exclusive Retail Space on Ground, 1st & 2nd Floor

### ADD ON EXPERIENCE

- Food Court
- Banquet Hall with stage, Buffet Section and fully functional kitchen

### IMPRESSIVE AMBIENCE

- Easy Driveway
- Air Conditioned Double Height Entrance Lobby
- 2 Car Lifts and 2 Elevators
- No turnstile
- Dual Entry and Exit
- Separate provision for Banquet Entry and Exit

## SUMER LIFE RETAIL AT A GLANCE

### PROJECT HIGHLIGHTS

- Total 102 Shops
- Individual Retail spaces units could be amalgamated to bigger floor plates
- Grand Designer AC Lobby
- 2 Car Lifts and 2 Elevators
- Modern fire detection Systems and Firefighting Equipment
- Earthquake Resistant Construction

\*Disclaimer: The information in this collateral is indicative of the kind of development that is proposed. Subject to the approval of the authorities or in the interest of continuing improvements, the developer reserves the right to change the layout, plans, specifications features, brands used or amenities without prior notice or obligation. The amenities shown inside the images in the brochure are purely indicative. All amenities, fixtures, brands, files, etc. mentioned in the brochure or displayed in the show/sample flats are subject to availability and quality checks of the specific design at the time of execution and implementation. This Advertisement/printed material does not constitute an offer or contract of any nature whatsoever between the promoters and the recipient. All transactions in this development shall be subject to and governed by the terms & conditions of the agreement for sale to be entered into between the parties. Carpet area is calculated as per Circular No. 4/2017 dated 14.06.2017 (MahaRera/Sec/File No. 27/84/2017) issued by Maharashtra Real Estate Regulatory Authority under the Real Estate (Regulation & Development) Act, 2016 and the rules and regulations made thereunder.

BEST OF INDULGENCES  
NEED THE WORLD'S BEST  
TO PERFECT



A Handpicked Collection of Luxury Experiences  
from the World-renowned Brands

Advocates & Solicitors  
M/S KISHORE THAKORDAS & CO.



Architect  
SUMER DESIGN CELL



Liaisoning Architect  
S.S ASSOCIATES



MEP Consultant  
RADIANT CONSULTING ENGINEERS



Structural Consultant  
J+W CONSULTANTS LLP

